

DETAIL & SUBMITTAL SHEET

CEILING ONLY

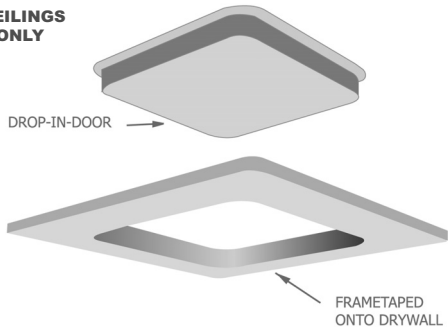

SPECIFICATIONS:

A state-of-the-art lightweight gypsum based formula that exceeds all required specifications that the market expects.

Manufactured from inorganic material and with 70% post-consumer recycled glass, using a patented composition that consistently provides a superior product. Our gypsum panel is lightweight and features exceptional definition, high compressive strength, and zero mold and fungus growth.

Moisture resistant, no warping, cracking or sagging.

Door & Frame: 5/8" lightweight Gypsum, drop in door

Finish: Unpainted natural grey Gypsum

Installation: Access panels are installed using standard supplies, screws are #6 bugle head. Joints are filled with standard tape and joint compound, then sanded. The access panel has edge thickness to accommodate 5/8" drywall. Therefore, shimming may be required if adjacent material is not 5/8".

Substrate material is determined by job site conditions. The panel does not require framing, but can be connected to adjacent drywall using blocks or studs.

FRONT ELEVATION

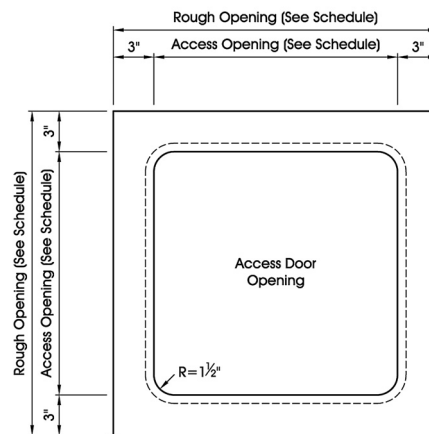

SECTION DETAIL

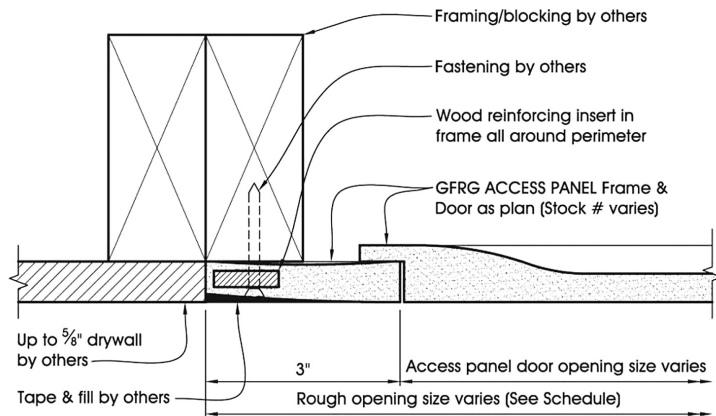

✓	Item No.	Door Opening	Rough Opening	Ship Wt. Lbs.
	GY 3000	12 x 12	18 x 18	5
	GY 3000	18 x 18	24 x 24	10
	GY 3000	24 x 24	30 x 30	15

Project: _____ Date: _____

Contractor: _____ Architect: _____

Sizes: _____ Quantity: _____ Approval Initials: _____

Distributed by
www.AccessDoor.com
 Phone: (800) 608-6568
 Fax: (409) 840-5545
 info@accessdoor.com



Corporate Office: 1330 Progress Drive • Front Royal, VA 22630